

REVISIONS			
REV	DESCRIPTION	DATE	APPROVED
01 ₀	RELEASED	KYLE 10/22/97	<i>PCW</i>
B	REVISED PER ECN 0U20-0262-01	GV 1/6/03	JGH

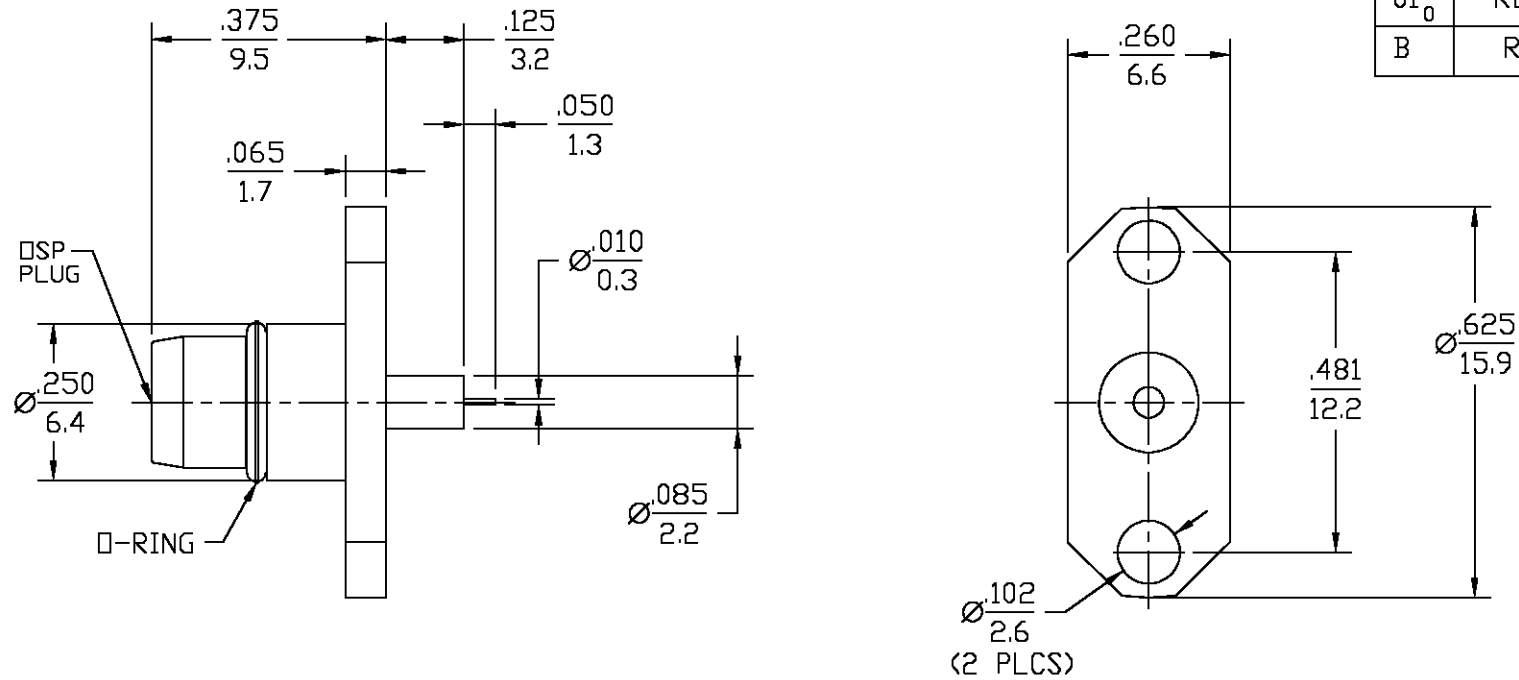

ELECTRICAL	MECHANICAL	ENVIRONMENTAL
Nominal Impedance (Ohms) 50	Interface Dimensions MIL-STD-348A	TEMPERATURE RATING -65° TO +125°C
Frequency Range (GHz) DC to 18	Fig. 321-1	Vibration MIL-STD-202, Method 204, Condition D
Volt Rating (VRMS MAX) @ Sea Level 335	Force to Engage (In-Lbs MAX) 3 & Disengage (In-Lbs MAX) 1.5	Shock MIL-STD-202, Method 213, Condition I
VSWR 1.07+.01f(GHz) DC to 18 GHz	Center Contact Captivation	Thermal Shock MIL-STD-202, Method 107, Condition B
Insertion Loss (dB MAX) .03x√F(GHz)	Axial (Lbs) 6.0	Moisture Resistance MIL-STD-202, Method 106
RF Leakage (dB MIN) (Fully Mated) -(60-F(GHz))	Weight (Grams) TBD	Corrosion - MIL-STD-202, Method 101, Condition B
Corona, 70,000 Ft (VRMS MIN) 250		
Dielectric Withstanding Voltage (VRMS MIN) @ Sea Level 1000		
Contact Resistance (Milliohms MAX) Center Contact 2.0 Outer Contact 2.0		
RF High Potential @ Sea Level (VRMS MIN @ 5 MHz) 670		
I.R.(Megohms MIN) 10000		

HOUSING	MATERIAL	FINISH
HOUSING	STAINLESS STEEL PER ASTM-A484 AND ASTM-A582, TYPE 303	PASSIVATE PER QQ-P-35
DIELECTRIC	PTFE FLUOROCARBON PER ASTM-D-1457	N/A
CENTER CONTACT	BERYLLIUM COPPER PER ASTM-B-196 OR ASTM-B-197, ALLOY C17300, CONDITION H	GOLD PLATE PER MIL-G-45204
O-RING	FLOUROSILICONE PER MIL-R-25988, CLASS I, TYPE I.	N/A
COMPONENT	MATERIAL	FINISH
UNLESS OTHERWISE SPECIFIED DIMENSIONS ARE IN INCHES	DATE 9/11/97	AMP AMP Incorporated 140 Fourth Avenue Waltham, MA 02451-7599
TOLERANCE ON	CHECKED BY	
FRAC. DEC. ANGLES ± 1/64 ±.005 ± 1°	APP'D BY <i>PCW</i> 10/2/97	
These drawings and specifications are the property of M/A-COM Incorporated and shall not be reproduced or copied or used in whole or in part as the basis for the manufacture or sale of item(s) without written permission.	USE ASS'Y PROCEDURE	TITLE DSP 2 HOLE FLANGE MOUNT PLUG RECEPTACLE STRAIGHT TERMINAL
NO. A.P. N/A	SIZE B	CODE IDENT NO. 26805
		4551-5054-02
		REV 01 ₀
	SCALE 4:1	SHEET 1 OF 1

CUSTOMER DRAWING

AMP PART # 1223149-1
SHEET 1 OF 1 REV B